

SECTION A-A

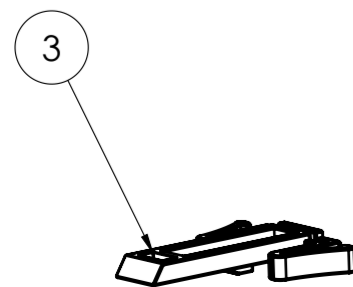

BODY ENCLOSURE

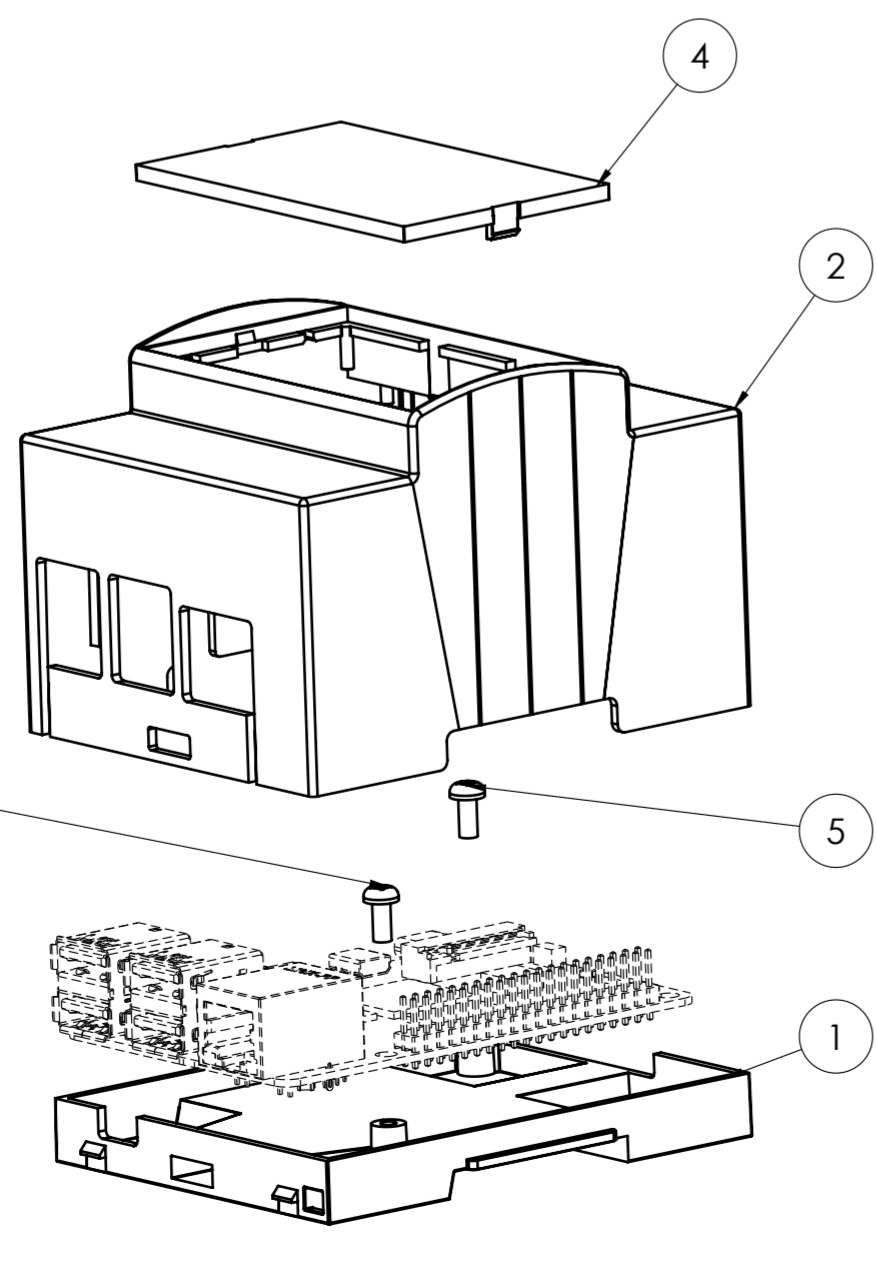
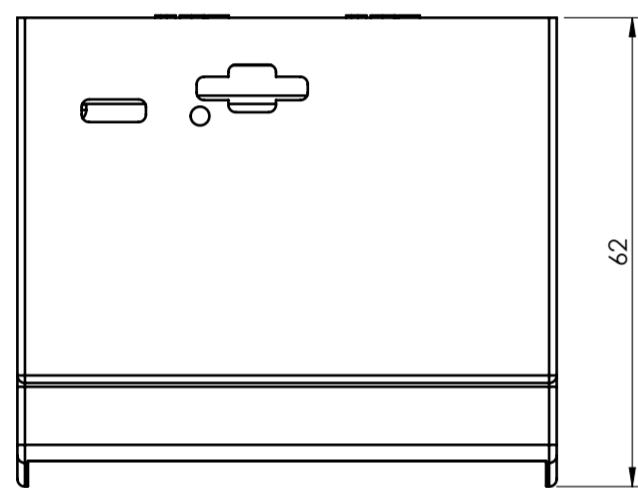
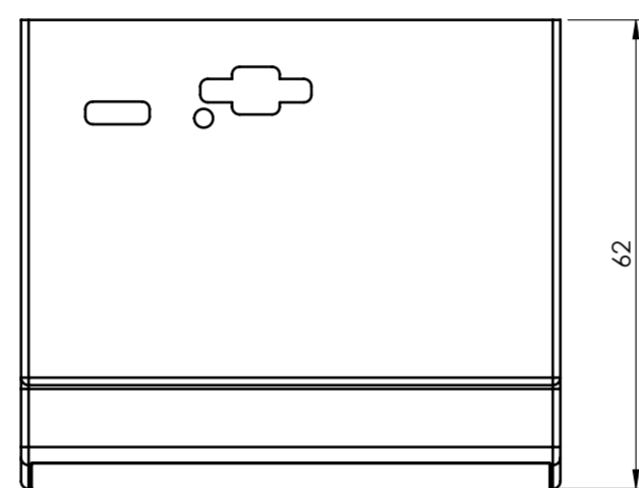
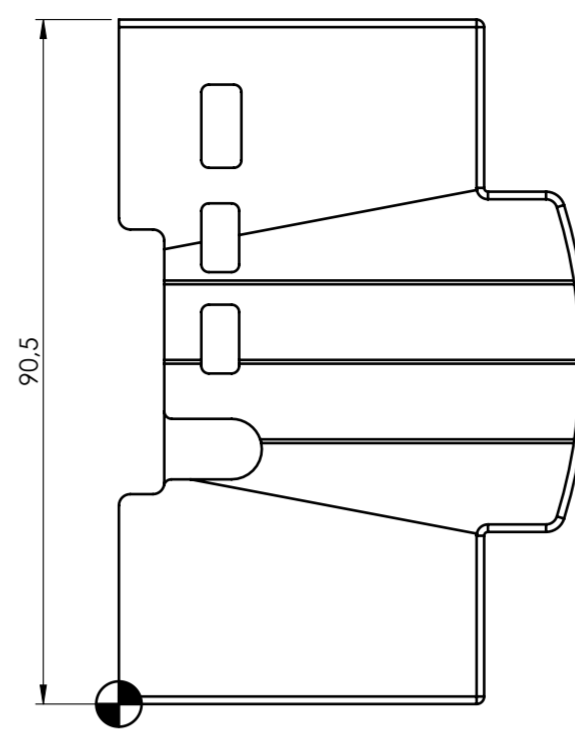
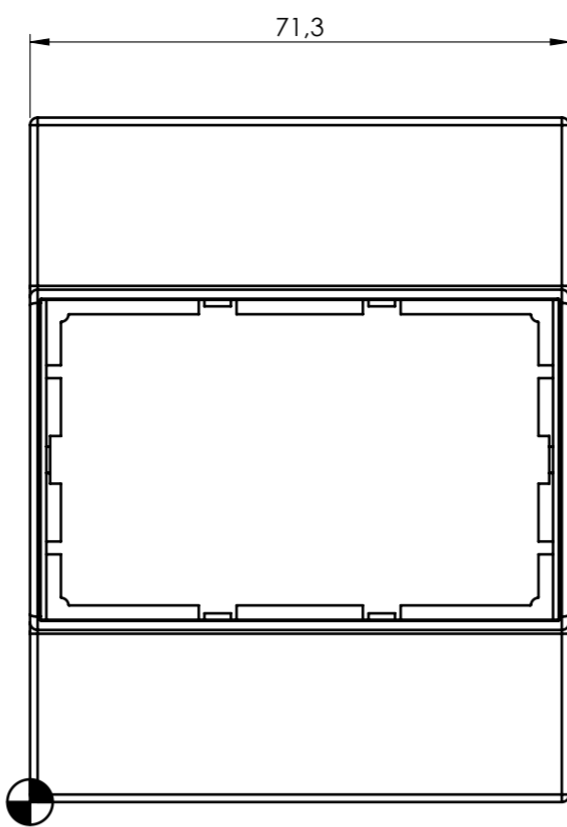

PANEL

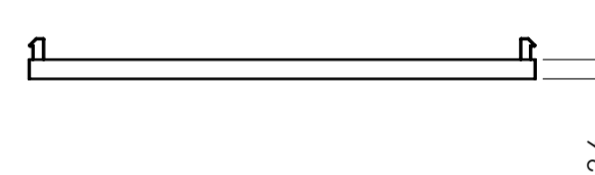
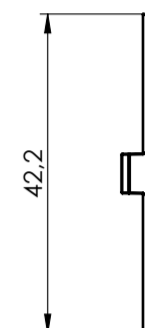
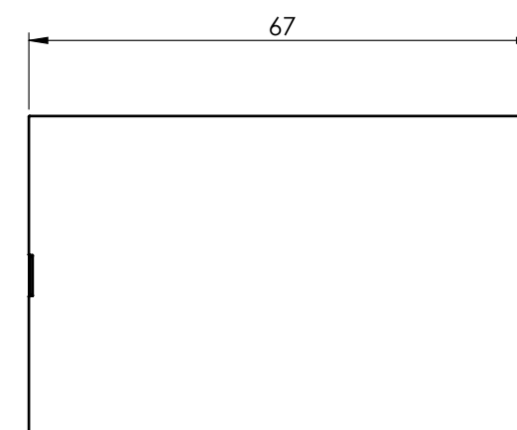

BASE

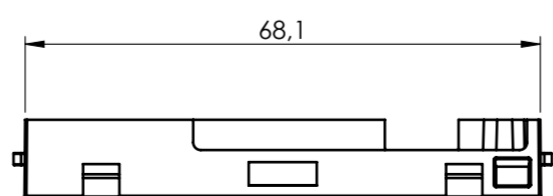
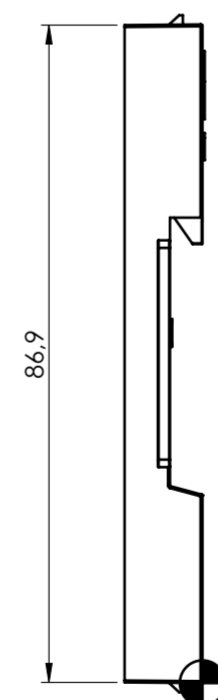
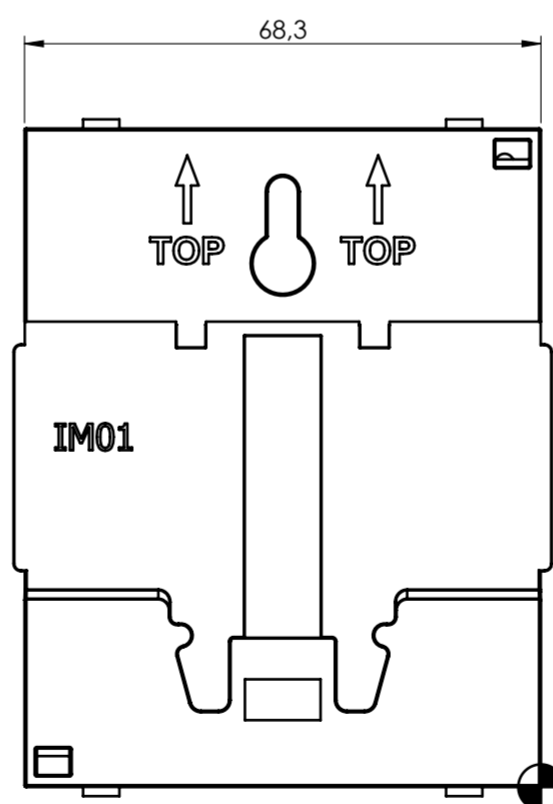

HOOK

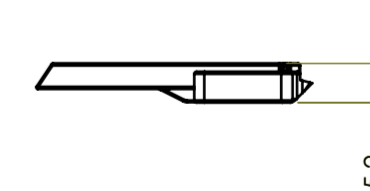
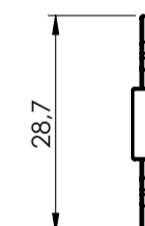
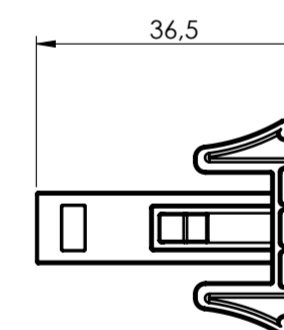

General information:  
 - Workpiece zero point for mechanical processing  
 - Minimum recommended radius for machining = R1.0 mm  
 - Mounting rail like EN 60715: TH 35-7.5 or TH 35-15  
 - Recommended PCB outline on [www.italtronic.com](http://www.italtronic.com)

RIF.	Q.TY	DRAWING	DESCRIPTION
1	1	2_050_00025	BASE MODULBOX XT-XTS 4M
2	1	2_050_00052	BODY ENCLOSURE 4M53-C XTS ROCK 5A
3	1	2_250_00072	HOOK FOR MODULBOX XT-XTS
4	1	2_250_00088	PANEL MODULBOX WITHOUT FRAME 4M
5	2	8_100_00003	SCREW d 2.9 X 6.5 TC+ TRUNK-POINT

General Tolerance UNI EN 22768/1 Media (m)						Sheet:
from 0.5 to 3	from 3 to 6	from 6 to 30	from 30 to 120	from 120 to 400		1
± 0.1	± 0.1	± 0.2	± 0.3	± 0.5		
Scale:	IM:	Drawn:	Checked:	Date:	Material:	Process:
1:1	--	R.N.	R.N.	06/12/2023		
Dimension in mm		Replaces the:		Derived from:	Weight:	Cod. Mold:
		--		--	gr	--

**italtronic**  
 enclosures for electronics  
[italtronic.com](http://italtronic.com)

Description:  
 KIT MODULBOX 4M XTS ROCK 5A  
 KIT MODULBOX 4M XTS ROCK 5A  
 Drawing nr.:  
**3\_050\_00044**

Rev.:  
**00 A2**