

Strip Block for Snap-in Mounting with up to 7 IEC Appliance Outlets F

new

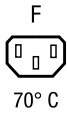

See below:
[Approvals and Compliances](#)

Description

- Panel mount
- Snap-in version front side (1.2 / 1.5 / 1.7 mm)
- Configurable Strip block from 2 up to 7 outlets type F
- Cord retention for cordsets with V-Lock, Twylock or P-Lock
- Pre-assembled Light Pipe for status indication
- Solder / PCB / QC (4.8 / 6.3 x 0.8) mm

Unique Selling Proposition

- Configurable Bus bar (L, N, PE)
- Optionally with or without light pipes on L or N side
- Color coding in black, grey or white
- Solder / PCB / QC (4.8 / 6.3 x 0.8 mm)

Characteristics

- Compact solution for intelligent PDU applications
- Suitable for use in equipment according to IEC/UL 62368-1

Other versions on request

- Other panel thickness
- Other Light Pipe lengths
- Color coding in White and Grey
- Other terminals on request

Weblinks

[pdf data sheet](#), [html datasheet](#), [General Product Information](#), [Approvals](#), [Distributor-Stock-Check](#), [Detailed request for product](#), [Landing Page](#)

The integration of light pipes in the appliance outlet provides status indication in smart PDUs. See PDU Landing Page for more information.
[Power Distribution Units](#)

Technical Data

Ratings IEC	10 A / 250 VAC; 50 Hz	Appliance inlet/-outlet	F acc. to IEC 60320-3
Ratings UL/CSA	15 A / 250 VAC; 60 Hz		UL 60320-1 CSA C22.2 no. 60320-1
Dielectric Strength	> 2 kVAC between L-N > 2 kVAC between L/N-PE (1 min/50 Hz)		(for cold conditions) pin-temperature 70 °C, 10 A, Protection Class I
Allowable Operation Temperature	-25 °C to 70 °C pin temperature		
IP-Protection	front side IP20 acc. to IEC 60529		
Protection against electric shock	Suitable for appliances with protection class I acc. to IEC 61140		
Terminal	Solder / PCB / QC (4.8 / 6.3 x 0.8) mm		
Panel Thickness S	Snap-in (1.2 / 1.5 / 1.7) mm tolerance +0.0/-0.1		
Light Pipe Length L	24.5 / 27.5 / 28.5 / 32.7 / 37.4 / 50.0 mm		
Material: Housing	Thermoplastic, black / grey / white, UL 94V-0		

Approvals and Compliances



Detailed information on product approvals, code requirements, usage instructions and detailed test conditions can be looked up in [Details about Approvals](#)

SCHURTER products are designed for use in industrial environments. They have approvals from independent testing bodies according to national and international standards. Products with specific characteristics and requirements such as required in the automotive sector according to IATF 16949, medical technology according to ISO 13485 or in the aerospace industry can be offered exclusively with customer-specific, individual agreements by SCHURTER.

Approvals





The approval mark is used by the testing authorities to certify compliance with the safety requirements placed on electronic products.

Approval Reference Type:

Approval Logo	Certificates	Certification Body	Description
	VDE Approvals	VDE	VDE Certificate Number: 40048640
	UL Approvals	UL	UR File Number: E502078
	CCC Approvals	CCC	CCC Certificate Number: 2018180204005769

Product standards

Product standards that are referenced

Organization	Design	Standard	Description
	Designed according to	IEC 60320-1	Appliance couplers for household and similar general purposes
	Designed according to	IEC 60320-3	Appliance couplers for household and similar general purposes
	Designed according to	UL 60320-1	Standard for Attachment Plugs and Receptacles
	Designed according to	CSA C22.2 no. 60320-1	General Use Receptacles, Attachment Plugs, and Similar Wiring Devices



Application standards

Application standards where the product can be used

Organization	Design	Standard	Description
	Suitable for applications acc.	IEC/UL 62368-1	Audio/video, information and communication technology equipment - Part 1: Safety requirements

Compliances

The product complies with following Guide Lines

Identification	Details	Initiator	Description
	RoHS	SCHURTER AG	Directive RoHS 2011/65/EU, Amendment (EU) 2015/863
	China RoHS	SCHURTER AG	The law SJ / T 11363-2006 (China RoHS) has been in force since 1 March 2007. It is similar to the EU directive RoHS.
	REACH	SCHURTER AG	On 1 June 2007, Regulation (EC) No 1907/2006 on the Registration, Evaluation, Authorization and Restriction of Chemicals 1 (abbreviated as "REACH") entered into force.

Dimensions [mm]

Socket Length

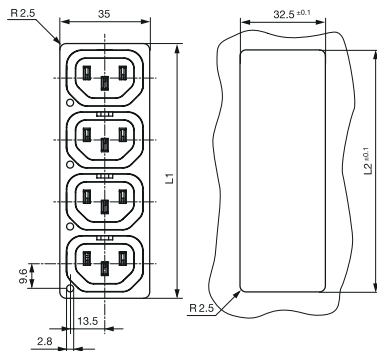

Number of Outlets	Socket Length (L1) mm	Panel cut-out Length (L2) mm
2	51.2 mm	48.3 mm
3	75.2 mm	72.3 mm
4	99.2 mm	96.3 mm
5	123.2 mm	120.3 mm
6	147.2 mm	144.4 mm
7	171.2 mm	168.4 mm

Max. Hight Socket + Terminal

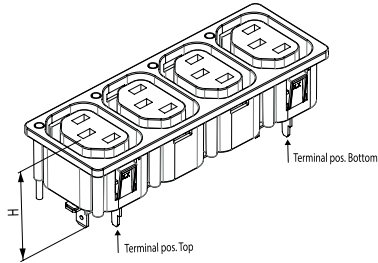

Terminal Variation	Maximum Height (H) mm
Solder Terminal	31.30 mm
PCB Terminal	34.20 mm
QC 4.8 Terminal	35.20 mm
QC 6.3 Terminal	36.80 mm

Snap-In and Light-Pipes

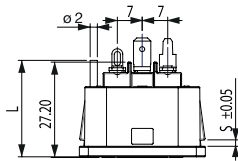

Lightpipe length (L) mm	Panel thickness Snap-In (S) mm
27.5 mm	1.20 mm
32.7 mm	1.50 mm
37.4 mm	1.70 mm
50.0 mm	
28.5 mm	
24.5 mm	

Drilling diagram for PCB terminals: All bussed [mm]

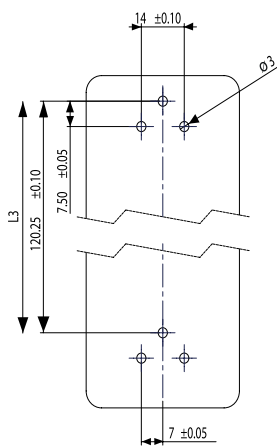

Drilling diagram for PCB terminals: L individua andl N/PE bussed [mm]

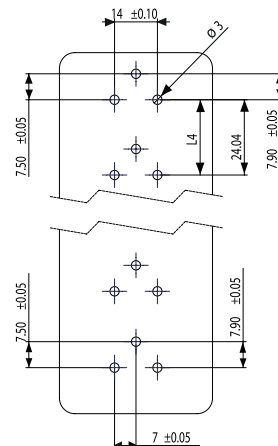

Drilling diagram for PCB terminals: L/N individual and PE bused [mm]

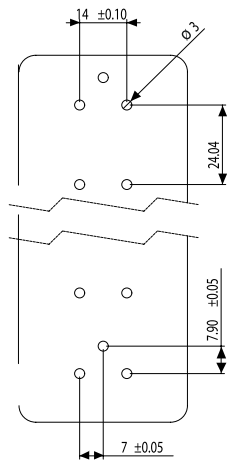

Drilling diagram for PCB terminals: L/N/PE individual [mm]

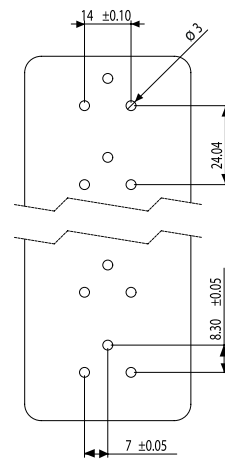

Number of Outlets	Drilling diagram for bused type PCB terminal Length (L3) mm	Drilling diagram for individual type PCB terminal Length (L4) mm
2	32.74 mm	24.4 mm
3	56.74 mm	24.4 mm
4	80.74 mm	24.4 mm
5	104.74 mm	24.4 mm
6	128.74 mm	24.4 mm
7	152.74 mm	24.4 mm

All Variants

Outlets	Panel Thickness [mm]	Light pipe L side	Light pipe N side	Color	Hard-Wired Bus	Position of Terminal on bus	Terminal type	Order Number
2	1.5 mm	L=27.5 mm	-	black	L individual, N/PE bused	Top and bottom	QC 4.8 x 0.8 mm	3-135-277
2	1.5 mm	L=27.5 mm	-	white	L individual, N/PE bused	Top and bottom	QC 4.8 x 0.8 mm	3-135-278
2	1.5 mm	-	-	black	L/N/PE bused	Top and bottom	Solder	3-135-157
2	1.5 mm	-	-	black	L/N/PE bused	Bottom	Solder	3-124-296
3	1.5 mm	L=27.5 mm	L=27.5 mm	black	L/N individual, PE bused	Bottom	PCB	3-124-314
3	1.5 mm	L=27.5 mm	-	black	L individual, N/PE bused	Top and bottom	QC 4.8 x 0.8 mm	3-135-586
3	1.5 mm	L=27.5 mm	-	white	L individual, N/PE bused	Top and bottom	QC 4.8 x 0.8 mm	3-135-539
3	1.5 mm	-	-	black	L/N/PE bused	Bottom	Solder	3-124-302
3	1.5 mm	-	-	black	L/N/PE bused	Top and bottom	Solder	3-135-537
3	1.7 mm	-	-	black	L/N/PE bused	Top	Solder	3-104-399
4	1.5 mm	-	-	black	L/N/PE individual	Not bused	PCB	3-104-370
4	1.5 mm	-	L=27.5 mm	black	L individual, N/PE bused	Top	PCB	3-104-412
4	1.5 mm	L=27.5 mm	L=27.5 mm	black	L individual, N/PE bused	Bottom	PCB	3-124-315
4	1.5 mm	L=27.5 mm	-	black	L individual, N/PE bused	Top and bottom	QC 4.8 x 0.8 mm	3-135-540
4	1.5 mm	L=27.5 mm	-	white	L individual, N/PE bused	Top and bottom	QC 4.8 x 0.8 mm	3-135-541
4	1.5 mm	L=27.5 mm	L=27.5 mm	white	L/N/PE bused	Top	QC 6.3 x 0.8 mm	3-128-802

Outlets	Panel Thickness [mm]	Light pipe L side	Light pipe N side	Color	Hard-Wired Bus	Position of Terminal on bus	Terminal type	Order Number
4	1.5 mm	-	-	black	L/N/PE bussed	Bottom	Solder	3-124-303
4	1.5 mm	-	-	black	L/N/PE bussed	Top	Solder	3-104-400
5	1.5 mm	-	-	black	L individual, N/PE bussed	Top and bottom	QC 4.8 x 0.8 mm	3-135-284
5	1.5 mm	L=27.5 mm	-	black	L individual, N/PE bussed	Top and bottom	QC 4.8 x 0.8 mm	3-135-292
5	1.5 mm	L=27.5 mm	-	white	L individual, N/PE bussed	Top and bottom	QC 4.8 x 0.8 mm	3-135-293
5	1.5 mm	-	-	black	L/N/PE bussed	Bottom	Solder	3-124-304
6	1.5 mm	-	-	black	L/N/PE individual	Not bussed	PCB	3-104-371
6	1.5 mm	L=27.5 mm	L=27.5 mm	black	N individual, L/PE bussed	Top	PCB	3-120-308
6	1.5 mm	L=27.5 mm	L=27.5 mm	black	L/N individual, PE bussed	Top	PCB	3-120-309
6	1.7 mm	L=27.5 mm	L=27.5 mm	black	L/N individual, PE bussed	Bottom	PCB	3-128-805
6	1.5 mm	L=27.5 mm	L=27.5 mm	black	L individual, N/PE bussed	Bottom	PCB	3-124-317
6	1.5 mm	L=27.5 mm	L=27.5 mm	black	L/N individual, PE bussed	Bottom	PCB	3-124-308
6	1.5 mm	L=27.5 mm	-	black	L individual, N/PE bussed	Top and bottom	QC 4.8 x 0.8 mm	3-135-552
6	1.5 mm	L=27.5 mm	-	white	L individual, N/PE bussed	Top and bottom	QC 4.8 x 0.8 mm	3-135-553
6	1.5 mm	-	-	black	L/N/PE bussed	Top and bottom	QC 6.3 x 0.8 mm	3-120-305
6	1.7 mm	-	-	black	L/N/PE bussed	Top and bottom	Solder	3-128-806
6	1.5 mm	-	-	black	L/N/PE bussed	Bottom	Solder	3-124-305
6	1.5 mm	-	-	black	L/N/PE bussed	Top	Solder	3-104-402
7	1.5 mm	-	-	black	L individual, N/PE bussed	Top and bottom	QC 4.8 x 0.8 mm	3-135-294
7	1.5 mm	L=27.5 mm	-	black	L individual, N/PE bussed	Top and bottom	QC 4.8 x 0.8 mm	3-135-295
7	1.5 mm	L=27.5 mm	-	white	L individual, N/PE bussed	Top and bottom	QC 4.8 x 0.8 mm	3-135-296
7	1.5 mm	-	-	black	L/N/PE bussed	Bottom	Solder	3-124-306

Most Popular.

Availability for all products can be searched real-time: <https://www.schurter.com/en/Stock-Check/Stock-Check-SCHURTER>

Mating Inlets/Plugs

Category / Description

[Plug Overview complete](#)



4732, Mounting: Power Cord, Plug: IEC E, Cable	4732
4735, Mounting: Power Cord, Plug: IEC E, Cable	4735
9009, Mounting: Plug: IEC E, Screw clamps	9009
4733, Mounting: Power Cord, Plug: IEC E, Cable	4733
4736, Mounting: Power Cord, Plug: IEC E, Cable	4736

...